



the LED lighting source™
 COMMERCIAL • LANDSCAPE • ARCHITECTURAL • RESIDENTIAL

15 Brownridge Rd. Unit 6, Halton Hills, ON L7G 0C6 • 905-487-8192 • 1-877-LED-2DAY • SGiLighting.com

Project: _____

Client: _____

Part #: UND-P-18W-CMP-ov - COP - 45 - RGB

Date: / / Qty: _____

SPECIFICATION

LED Underwater Light • 18 Watt Compass RGB



Operating Voltage (ov)	12V DC	Constant Voltage
Finish (fin)	COP	Copper
Beam Angle (ba) Degrees	45°	
Light Colour (lc) Correlated Colour Temperature (CCT)	RGB	Colour Changing varies Also available in Whites and Single Colours Please see individual product spec sheets
Light Output Lumens	RGB White	1710
IP Rating	IP68	
Dimension Diameter, Heights	D	4.17" 106 mm
	H	3.23" 82 mm with bracket
	H	1.77" 45 mm without bracket
Housing	Copper	
Watts	18W	
Light Source	6 x 3W RGB LED	3 in 1 RGB
Input Voltage	AC 100V – 240V, 277V	external transformer
Dimmable	Yes – with dimmable transformer	
Operating Temperature	-25°C to +50°C	-13°F to 122°F
Life Lumen Maintenance	50,000 hours	

Part Number Configuration – UND-P-18W-CMP-ov-fin-ba-lc

Category	Grade	Family	Operating Voltage (ov)	Finish (fin)	Beam Angle (ba)	Light Colour (lc)
UND	P-Professional	18W CMP	12VDC	COP Copper	45°	RGB

* Available on special order



the LED lighting source™
 COMMERCIAL • LANDSCAPE • ARCHITECTURAL • RESIDENTIAL

15 Brownridge Rd. Unit 6, Halton Hills, ON L7G 0C6 • 905-487-8192 • 1-877-LED-2DAY • SGIlighting.com

Project: _____

Client: _____

Part #: UND-P-18W-CMP-ov-COP-45-RGB

Date: / / Qty: _____

INSTALLATION

LED Spot Light • 18 Watt Compass RGB • Installation Guide

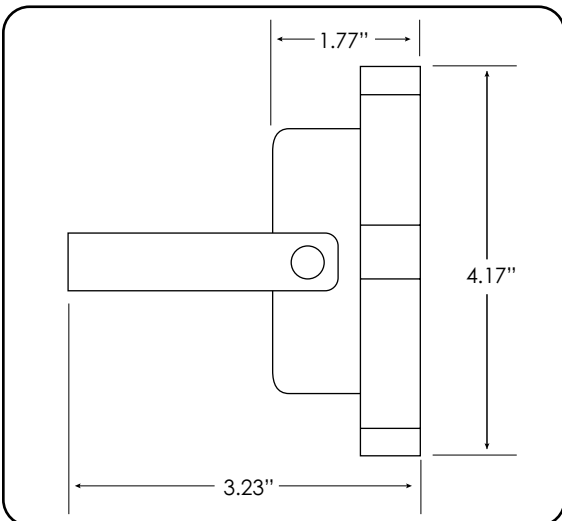
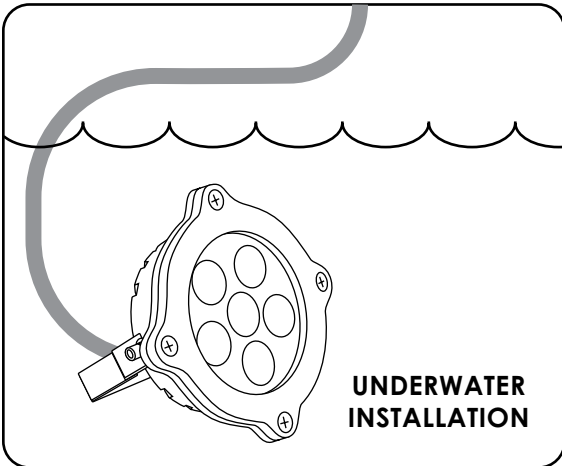
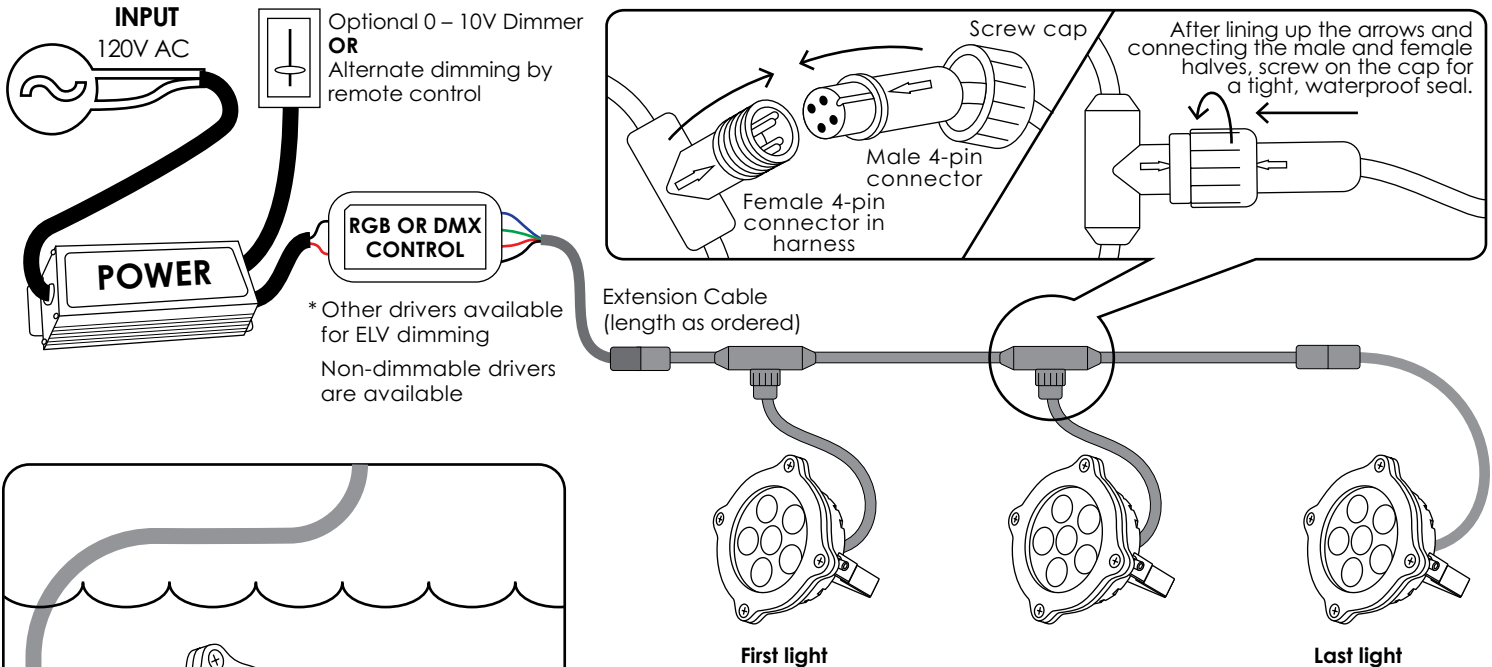

QUICK CONNECT OPTION

- Using the Quick Connections (shown above), connect all of the lights together then connect the first light to the controller.

Make sure the arrows on the female connector and the male connector are lined up.

- Tighten the screw caps around the connectors to ensure a waterproof connection.

- Connect lights to controller. **Please refer to Controller installation pages for detailed wiring instructions.**

- Connect transformer to line voltage.

OR

HARDWIRE OPTION

- Connect a main line of 14 or 16 AWG two conductor shielded cable from transformer to furthest light.

- Connect each light to main cable run coming from the transformer in parallel connection as shown above.

Black wire from Light (V+) to Black wire from cable (V+)

Red wire from Light (R) to Red wire from cable (R)

Green wire from Light (G) to Green wire from cable (G)

Blue wire from Light (B) to Blue or White wire from cable (B)

